

Draft of a tract of land situate in the township of Lehman in Luzerne County adjoining John Eley and others containing two hundred and seventy two acres and Thirteen perches of land besides the usual allowance of 6 pr. et. for roads &c - Surveyed the above described tract of land the 11th. day of March 1839 for George M. Hollenback by virtue of his Warrant dated the 25th day of Sept: 1838

To John Taylor Esq^r Surveyor Gen^l

T. W. Stevens D.S.
for Luzerne County.

Certified and approved by me this 16th day of January A^o D^o 1840.

Newry Coll. D.S.

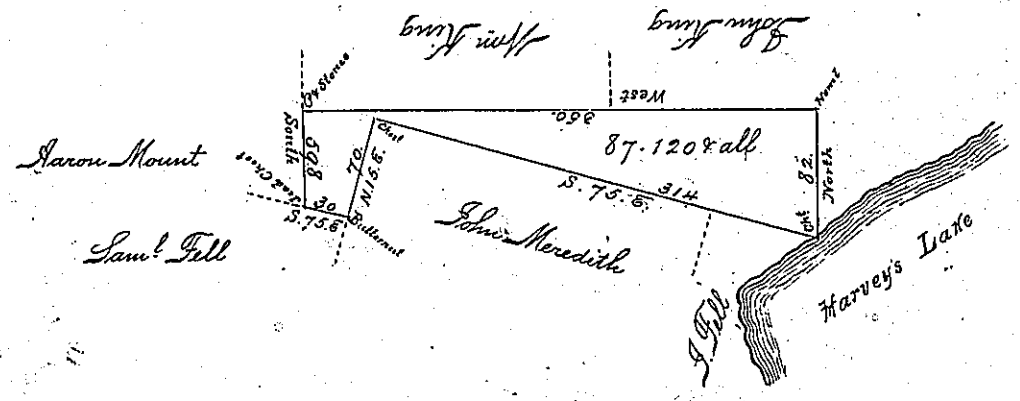

Draft of a tract of land situate in Lehman township Luzerne County adjoining John King and others - containing Eighty seven acres, one hundred & twenty perches of land besides the usual allowance of 6 pr. et. for roads &c - Surveyed the above described tract of land the 3rd day of May 1839 for George M. Hollenback, by virtue of his Warrant dated the 12th day of March, 1839.

To John Taylor Esq^r Suror^g Gen^l

T. W. Stevens D.S.
for Luzerne County

Certified and approved by me this 16th day of January A^o D^o 1840.

Newry Coll. D.S.

IN TESTIMONY that the above is a copy of the original remaining on file in the Department of Internal Affairs of Pennsylvania, made conformably to an Act of Assembly approved the 16th day of February, 1833, I have hereunto set my Hand and caused the Seal of said Department to be affixed at Harrisburg, this

Second day of November 1897.

James W. Latta
Secretary of Internal Affairs.